



340S

Commercial Sectional Doors
1½" Insulated Sections

340S

Sandstone Microgroove Panel with 24" X 12" Windows



340S

Formally marketed as H-340S

BETTER



Door: 10 yr



Hardware: 1 yr



Springs: 1 yr

- **R-7.4** Thermal Rating
- Steel Construction
- 1½" Polystyrene
- 4 Colors
- 3 Panel Designs
- 2 Window Designs

Thermal Rating



Durability



Low Maintenance

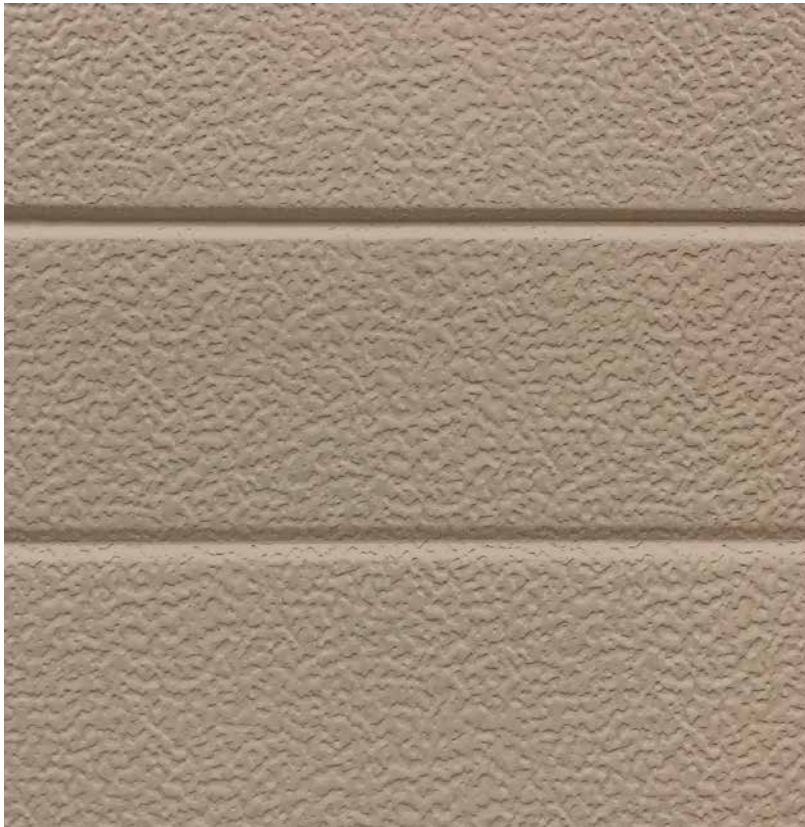

Section Detail

SECTION DETAIL 340S panels are produced in stucco texture for microgroove design or woodgrain texture for flush & raised panel designs. The door panels are prepared inside and out to offer maximum protection to provide you with a long-lasting surface finish and reduced maintenance cost.

Left Facing Page Image:

Sandstone microgroove panel with 24" X 12" windows

Bottom Left Image:

Close-up of a microgroove panel with stucco texture

340S

Panel Features

The Industry Leader in Innovative Door Strength and Energy Efficiency

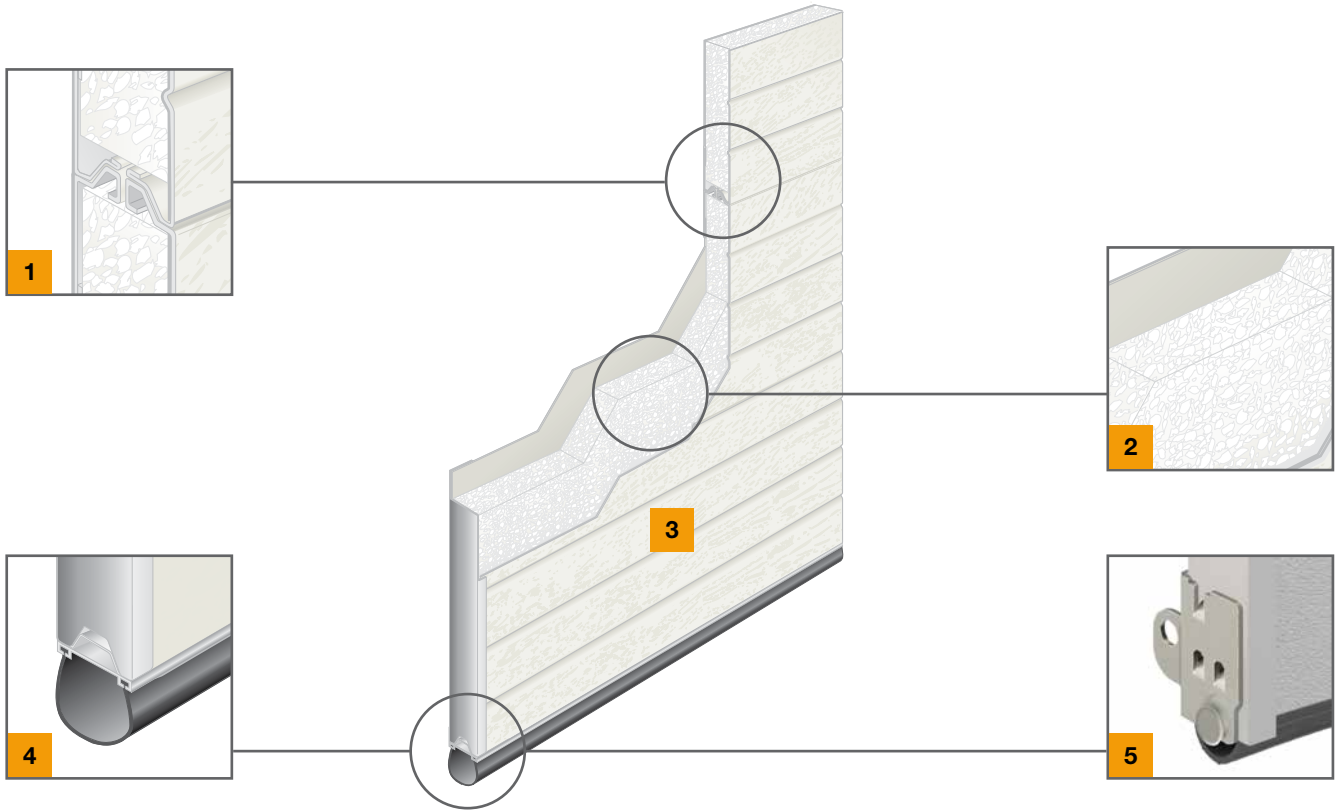

Tongue & Groove Section Joints **1**

Precisely designed thermally broken section joints reduce air infiltration and create weather tight seal.

Sandwich Construction **2**

3-layer steel front and back construction with insulating polystyrene core increases energy savings.

Panel surface treatment **3**

Galvanized finished painted steel provides superior corrosion resistance for years of trouble-free performance.

Bottom Weather Seal **4**

Keeps out wind, rain, debris and other elements for added energy savings.

Proprietary Safety Brackets **5**

Our reinforced safety bottom brackets and red safety screws create a double layer of built-in safety for the user.

Panel Design

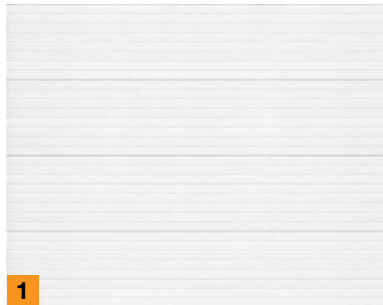

1



2

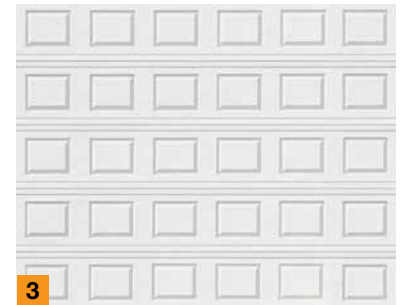

3

- 1 Microgroove
- 2 Flush
- 3 Traditional Raised Panel



1

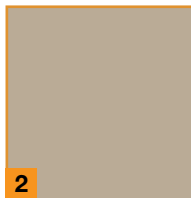

2



3

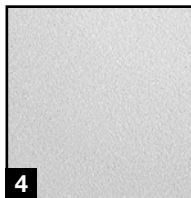

4

Color Options

- 1 White
- 2 Sandstone
- 3 Brown
- 4 Metallic Silver (Optional)

Window Design Options



1

1 Window 24" X 6"



2

2 Window 24" X 12"

Door Width	Maximum No. of Windows
Up to 9' 2"	2
9' 3" to 12' 2"	3
12' 3" to 16' 2"	4
16' 3" to 18' 2"	5

HÖRMANN NORTH AMERICA



Sparta, TN - North American Headquarters / Sectional Doors

FIVE PRODUCTION PLANTS, ONE FAMILY



Puyallup, WA - Sectional Doors



Montgomery, IL - Sectional Doors



Barrie, ON (CAN) - High Performance Doors



Burgettstown, PA - High Performance Doors

As one of the world's leading manufacturers of doors we're committed to providing the best quality, value, and selection.

Whether residential, commercial or industrial, we have the door you're looking for. Each Hörmann product gives you the perfect array of benefits and options to satisfy your customers.

Call toll free

Eastern & Central US: 877.654.6762

Western US: 800.522.2264

Canada: 833.743.2443

Contact

Email: info@hormann.us

Website: hormann.us

Follow us on social media



AVAILABLE FROM:

